

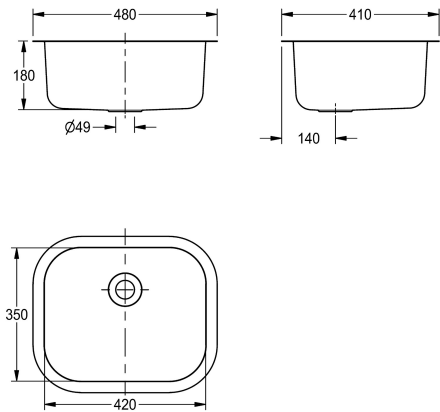

**KWC SIRIUS**  
Small inset sink bowl

**Modell-Linie: SIRIUS | C20137N**  
Washbasins & Washtroughs | Wash basins



**KWC-No.**

**2000100324**

Basin to be installed from above, dimensions 480 x 180 x 410 mm (W x H x D)

Small rimmed edged bowl for inseting into worktops. Manufactured from 0.9 mm thick grade 1.4301 (304) stainless steel with a satin polish finish. The bowl has a 17 mm rimmed edge and is prepared for a 38 mm waste and overflow. There are no tap holes therefore taps are to be mounted through the worktop or on the wall. Fixing clips are supplied with each bowl. Waste, plug, chain and overflow are available extras.

NOTE: It may be necessary to notch the worktop when fitting an overflow.

17 mm rimmed edge  
Centre waste  
Dimensions 420 x 350 x 180 mm (W x H x D)  
Cut-out size 400 x 500 mm

**Technical Data**

bowl - bowl height
bowl finish
bowl - depth
bowl shape
bowl - width
material
material code
material thickness
overall depth
overall height
overall width
overflow
rear upstand
splash back
surface finish
tap ledge
type of mounting
waste hole position
waste kit included
waste size

180 mm
satin finished
420 mm
rounded rectangle
350 mm
stainless steel
1.4301 Chrome Nickel steel V2A
0.9 mm
410 mm
180 mm
420 mm
yes
no
no
satin finished
no
inset mounting
right back corner
yes
DN 40