

## KWC HEAVY-DUTY Single washbasin

Modell-Linie: HEAVYDUTY | HDTX450  
Washbasins & Washtroughs | Wash basins

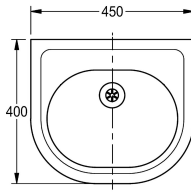
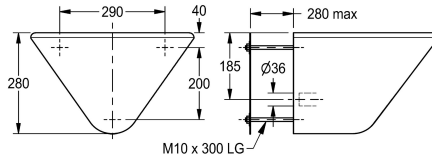

### KWC-No.

**2000100349**

Dimensions 450 x 280 x 400 mm (W x H x D)

Single wash basin for wall mounting, stainless steel, surface satin finished, material thickness 1.2 mm, with 3 threaded rods for mounting through the wall via a service room, seamless welded bowl, 40 mm tap ledge, without taphole, without overflow, 1 1/4"

flat perforated waste, includes hidden mounted siphon DN 32.

Dimensions 450 x 280 x 400 mm (W x H x D)

### Technical Data

type of basin
bowl position
bowl - bowl height
bowl finish
bowl - depth
bowl shape
bowl - width
colour
material
material code
material thickness
overall depth
overall height
overall width
overflow
rear upstand
siphon diameter
siphon included
spillway
splash back
surface finish
tap ledge
tap ledge position
type of mounting
type of waste kit
waste hole position

Wash basin
center
150 mm
satin finished
270 mm
oval
360 mm
No colour
stainless steel
1.4301 Chrome Nickel steel V2A
1.2 mm
400 mm
280 mm
450 mm
no
no
DN 32
no
no
no
satin finished
yes
opposing
bolt fix with duct wall
stem valve
centre back





## KWC HEAVY-DUTY

### Single washbasin

**Modell-Linie: HEAVYDUTY | HDTX450**  
Washbasins & Washtroughs | Wash basins

waste hole projection	155 mm
waste kit included	yes
waste size	DN 32
waste sleeve included	no