

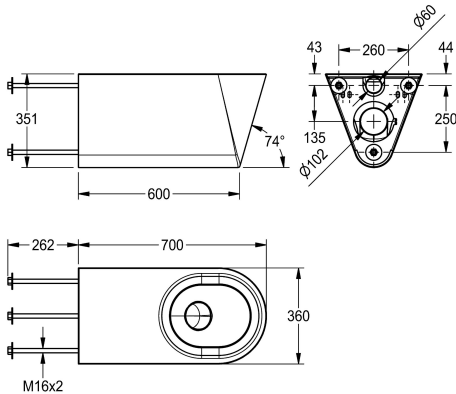

KWC HEAVY-DUTY  
Wall hung WC pan

Modell-Linie: HEAVYDUTY | HDTX594  
WCs and urinals | WCs



KWC-No.

2000100444

Dimensions 360 x 351 x 700 mm (W x H x D)

Wall hung WC pan for disabled, hidden mounting with stainless steel rods through wall, fixing and service via maintenance room, stainless steel, surface satin finished, material thickness 1,5 mm, flushing certificated to EN 997, concealed flushing rim with min. 4 liter flushing capacity, with a shrouded 100 mm diameter horizontal

'P' trap outlet, pressed seat area tapered towards centre, all edges curved, fixing with 280 mm stainless steel rods and screw nuts (included) through the wall.

Dimensions 360 x 350 x 700 mm (B x H x T)

Technical Data

inlet size	DN 55
material	stainless steel
material code	1.4301 Chrome Nickel steel V2A
material thickness	1.5 mm
minimum flushing capacity	4 Liter
outlet size	DN 100
overall depth	700 mm
overall height	351 mm
overall width	360 mm
surface finish	satin finished
type of mounting	bolt fix with duct wall
type of toilet seat	No seat
type of WC	wall hung

