

## KWC HEAVY-DUTY WC washbasin combination

Modell-Linie: HEAVYDUTY | HDTX815L  
Heavy Duty | Prison units

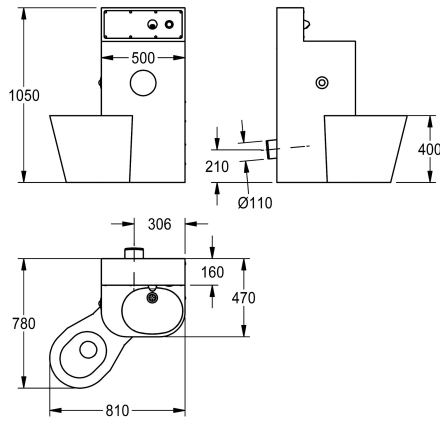

### KWC-No.

#### 2000100965

Version with WC pan angled 45° to the left

#### 2000100966

Version with centrally arranged WC pan Dimensions 500 x 1050 x 890 mm (W x H x D)

#### 2000100967

Version with WC pan angled 45° to the right Dimensions 810 x 1050 x 780 mm (W x H x D)

### WC position

left

middle

right

Chromium nickel steel WC wash basin combination, satin finish surface for installing against a wall, invisible fixing with grub screws, lockable inspection opening. Mounting stand, material thickness 2 mm with elevated rear wall including wall outlet and press button operation, seamless welded toilet paper roll compartment and seamless moulded oval wash basin with plastic trap. WC pan, material thickness 1.6 mm with full-length skirting, arranged on the left 45 degrees, bowl rim where nothing can hide,

flushing certified pursuant to EN 997, horizontal outlet at the back DN 100. Self-closing gate valve with remote control to connect to premixed hot water or cold water, closing automatically with no blow back. Condensation water-proof concealed cistern with single flush technology (9 or 6 litres) Including fixing material.

Overall dimensions 810 x 1050 x 780 mm (W x H x D)  
WC position on the left

### Technical Data

body width	500 mm
front access panel	yes
floor fixing joggle plate	no
inlet size	DN 15
material	stainless steel
material code	1.4301 Chrome Nickel steel V2A
material thickness body	2 mm
material thickness WC	1.5 mm
outlet size	DN 50 / DN 100
overall depth	780 mm
overall height	1,050 mm
overall width	810 mm
overflow	no
pipework material	stainless steel
self closing push buttons	mechanical
toilet roll holder diameter	153 mm
shroud design	round shape
soap dish	no
spout length	83 mm





**KWC HEAVY-DUTY**  
WC washbasin combination

**Modell-Linie: HEAVYDUTY | HDTX815L**  
Heavy Duty | Prison units

surface finish	satin finished
tap with integrated bubbler	no
type of flushing fitting	WC cistern
type of mounting	wall mounting
type of toilet seat	no seat
type of WC	floor standing
upper edge of basin height	850 mm
upstand depth	160 mm
upstand height	200 mm
WC height	400 mm
WC position	left