

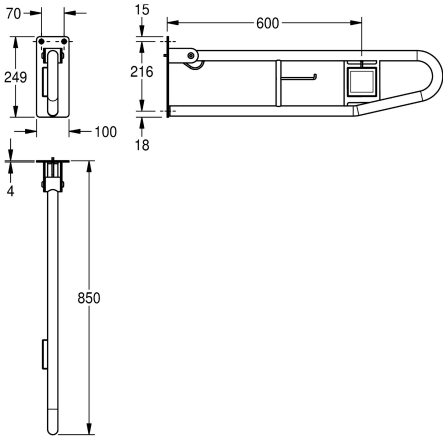

KWC CONTINA
Foldable grab rail with electronic flush button

Modell-Linie: CONTINA | CNTX72F-L
Grab rails | Grab rail



Article Number

- 2000103283**
Foldable grab rail with electronic flush button, flush trigger right
- 2000103284**
Foldable grab rail with electronic flush button, flush trigger left

Foldable grab rail with electronic flush button for wall mounting, stainless steel, surface satin finished, material thickness 1.2 mm, flush button left, rough polishing for better surface feel, 32 mm pipe diameter, stirrup shape, integrated toilet roll holder, electronic flush button in front area, prevention against unmeant folding, gum rubber stop absorber, load capacity up to 150 kg, 4 mm thick

Technical Data

| |
|--------------------|
| Orientation |
| back |
| hidden fixing |
| hinged |
| material |
| material code |
| material thickness |
| overall depth |
| overall height |
| overall width |
| surface finish |
| type of grab rail |
| type of mounting |

Orientation

- right
- left

mounting plate with three fixing holes, including stainless steel screws and dowels.

Dimensions 100 x 250 x 850 (W x H xD)
Protection class IP40

| |
|--------------------------------|
| left |
| no |
| no |
| yes |
| stainless steel |
| 1.4301 Chrome Nickel steel V2A |
| 1.2 mm |
| 850 mm |
| 250 mm |
| 100 mm |
| satin finished |
| support bar |
| wall mounting |