

KWC AQUALINE
WC flushing valve

Modell-Linie: AQRM554C
Flushing systems | Self closing wc flushing system

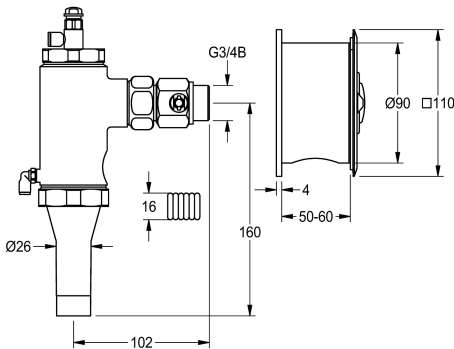

KWC-No.
2000103712
2000101061
Version without noise group I

AQUALINE WC flush valve DN 20 with noise group I with remote control, for vandal resistant applications, installation of flush valve

sound insulation
I-
no

outside the user room, remote control in wall installation box with stainless steel cover plate and metal push button.

Technical Data	
calculation flow rate cold wat	1 l/s
Cover plate height	110 mm
Cover plate width	110 mm
functional principle	hydraulic self-closing
diameter nominal	DN 20
material casing	stainless steel
material code casing	1.4301 Chrome Nickel steel V2A
material fitting	brass-look
maximum flow pressure	4 bar
maximum flushing flow	1.3 l/s
maximum flush water volume	9 Liter
minimum flow pressure	1.2 bar
minimum flushing flow	1 l/s
minimum flush water volume	6 Liter
protective shutdown	no
sound insulation	I-
surface finish casing	satin finished
surface finish fitting	raw
type of flushing fitting	WC flush valve
type of mounting	concealed
type of operation	manual operation
water connection	threaded connection (external)
Basic colour	stainless steel-look

Spare Parts



KWC AQUALINE
WC flushing valve

Modell-Linie: AQRM554C
Flushing systems | Self closing wc flushing system



Remote operation valve

2000104780
EFLSY0027

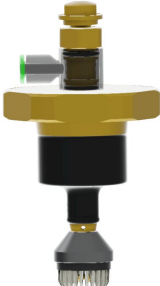

Upper part

2000104384
EFLSY0004

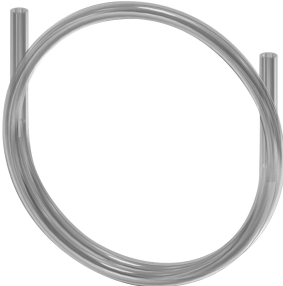

Remote operation hose

2000104803
EAQLN0019