

## KWC ANIMA Single washbasin

Modell-Linie: ANIMA | WT600C-M  
Washbasins & Washtroughs | Wash basins

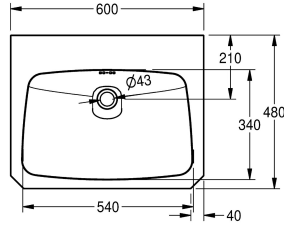
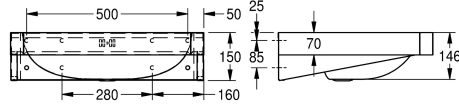

### KWC-No.

**2000103766**

With 35 mm diameter tap hole, centered

### number of tap holes

1

Single wash basin for wall mounting, stainless steel, surface satin finished, material thickness 1 mm, seamless welded bowl with diameter 550 x 350 x 145 mm, rectangular shape, 90 mm tap ledge, with overflow, 1 1/4" plug waste, drainage rewards centric, front panel with 45° corner edges, prewelded mounting brackets,

Abstand zwischen den Achsen der Befestigungslöcher lt. EN 31, includes screws and dowels.

With taphole  
Dimensions 600 x 150 x 480 mm (W x H x D)

### Technical Data

type of basin
bowl position
bowl - bowl height
bowl finish
bowl - depth
bowl shape
bowl - width
colour
material
material code
material thickness
overall depth
overall height
overall width
overflow
overflow position
rear upstand
siphon diameter
siphon included
splash back
surface finish
number of tap holes
tap hole diameter
tap hole position
tap ledge

Wash basin
center
146 mm
satin finished
340 mm
rounded rectangle
540 mm
No colour
stainless steel
1.4301 Chrome Nickel steel V2A
1 mm
480 mm
150 mm
600 mm
yes
back
no
DN 32
no
optional
satin finished
1
35 mm
middle
yes



## KWC ANIMA Single washbasin

Modell-Linie: ANIMA | WT600C-M  
Washbasins & Washtroughs | Wash basins

type of mounting	wall mounting
type of waste kit	plug waste
waste hole position	centre back
waste hole projection	210 mm
waste kit included	yes
waste size	DN 32
waste sleeve included	no

### Optional Accessories



#### ANIMA trap cover

**2000056723**  
ANMX210



#### ANIMA splash back

**2000100067**  
SB600

### Spare Parts

#### Fixing set

**2000103414**  
ECMPX023