

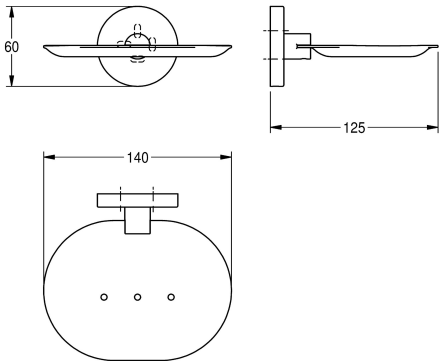

KWC FIRMUS
Soap tray

Modell-Linie: FIRMUS | FIRX107HP
Accessoires Hotel & Residential | Tumbler & soap holder



KWC-No.

2000106285
Surface high polished Dimensions 140 x 60 x 125 mm (W x H x D)

Soap dish for wall mounting, 304 stainless steel, round covers with drilled hole on bottom for fixation, includes stainless steel screws and dowels.

Technical Data

material
material code
overall depth
overall height
overall width
surface finish
type of fixing
type of mounting

surface finish

high polished

Surface high polished
Dimensions 140 x 60 x 125 mm (W x H x D)

stainless steel
1.4301 Chrome Nickel steel V2A
125 mm
60 mm
155 mm
high polished
screw
wall mounting