

KWC
Wash trough with wall-mounted tap holes

Modell-Linie: ACCESSOIRES | WTTWM1200
Washbasins & Washtroughs | Washtroughs

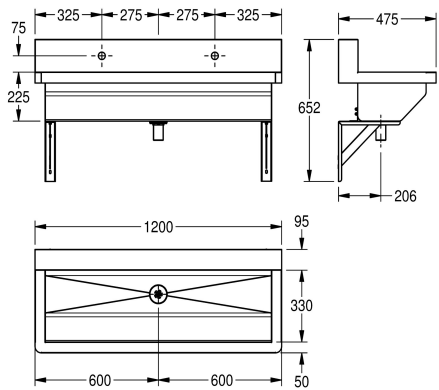

KWC-No.	overall width
2000106611	1,200 mm
2000106612	1,500 mm
2000106613	1,800 mm
2000106614	2,400 mm

Wash trough with wall-mounted tap holes for wall mounting is made of stainless steel Grade 304 (EN 1.4301), satin surface finished, easy to clean with radius corners, material thickness is 1.2 mm wash trough body, 1.5 mm rear wall mount off-set clip and

reinforcement brackets. Provided with waste fittings, taps are not included. Screws and dowels are included.

Width 1200 mm

Technical Data

material	stainless steel
material code	1.4301 Chrome Nickel steel V2A
material thickness	1.2 mm
number of waste holes	1
overall depth	475 mm
overall height	225 mm
overall width	1,200 mm
rear upstand	no
splash back	yes
surface finish	satin finished
number of tap holes	2
tap ledge	yes
type of mounting	wall mounting
number of wash places	2
waste hole position	centre
waste kit included	yes