

KWC
Wash trough with wall-mounted tap holes

Modell-Linie: ACCESSOIRES | WTTWM1800
Washbasins & Washtroughs | Washtroughs

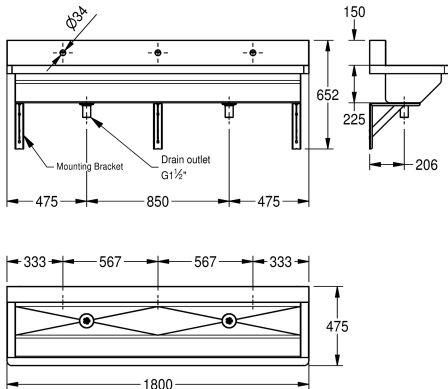

KWC-No.
2000106611
2000106612
2000106613
2000106614

overall width
1,200 mm
1,500 mm
1,800 mm
2,400 mm

Wash trough with wall-mounted tap holes for wall mounting is made of stainless steel Grade 304 (EN 1.4301), satin surface finished, easy to clean with radius corners, material thickness is 1.2 mm wash trough body, 1.5 mm rear wall mount off-set clip and

reinforcement brackets. Provided with waste fittings, taps are not included. Screws and dowels are included.

Width 1800 mm

Technical Data

material
material code
material thickness
number of waste holes
overall depth
overall height
overall width
rear upstand
splash back
surface finish
number of tap holes
tap ledge
type of mounting
number of wash places
waste hole position

stainless steel
1.4301 Chrome Nickel steel V2A
1.2 mm
2
475 mm
225 mm
1,800 mm
no
yes
satin finished
3
yes
wall and floor mounting
3
centre