

KWC ANIMA
Single washbasin

Modell-Linie: ANIMA | ANMX502
Washbasins & Washtroughs | Wash basins

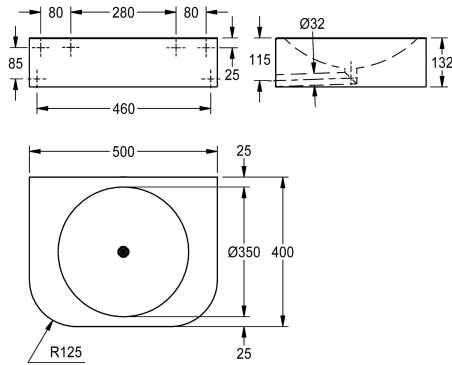

KWC-No.

2030029755
Dimensions 500 x 132 x 400 mm (W x H x D)

Single wash stand for wall-mounting, chrome-nickel steel, surface silk matt, material thickness 1.5 mm, barrier-free wash stand in acc. with SIA 500, seamlessly welded round basin, basin diameter of 350 mm, rectangular wash stand shape with front corners rounded, no bank of fittings, seamlessly integrated plug strainer and

drainpipe DN 32, siphon mounted under plaster, not included, integrated and reinforced assembly panel measuring 280 mm, includes stainless steel screws and rawl plugs.

Dimensions 500 x 132 x 400 mm (W x H x D)

Technical Data

type of basin
bowl - bowl height
bowl shape
bowl - width
material
material code
material thickness
overall depth
overall height
overall width
overflow
siphon included
type of mounting
waste hole position
waste kit included

single / multiple pay water di
83 mm
circle
350 mm
stainless steel
1.4301 Chrome Nickel steel V2A
1.5 mm
400 mm
132 mm
500 mm
no
no
wall mounting
centre
yes

