

KWC CONTINA 90° angled grab rail

Modell-Linie: CONTINA | CNTX21W
Grab rails | Grab rail

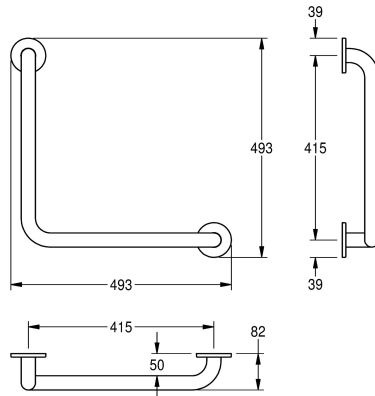

KWC-No.

2030038226

Dimensions 493 x 493 x 82 mm (W x H x D)

90° angle grab rail for wall mounting, stainless steel, surface satin finished, rough polishing for better surface feel, 32 mm pipe diameter, material thickness 1.2 mm, wall distance 82 mm, with two stainless steel covers for hidden mounting, includes stainless

steel screws and dowels.

Dimensions 493 x 493 x 82 mm (W x H x D)

Technical Data

bending angle
colour
number of fixing points
hidden fixing
hinged
material
material code
material thickness
overall depth
overall height
overall width
pipe diameter
surface finish
type of fixing
type of grab rail
type of mounting

90 Degree
No colour
2
yes
no
stainless steel
1.4301 Chrome Nickel steel V2A
1.2 mm
82 mm
493 mm
493 mm
32 mm
satin finished
screw
angle bar
wall mounting