

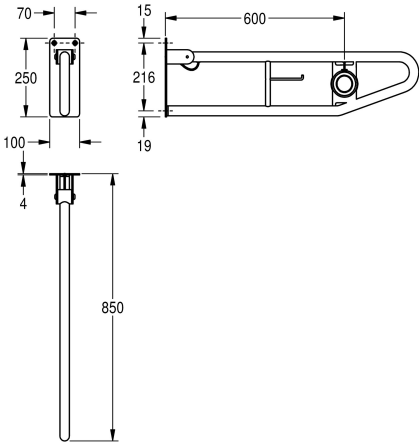

KWC CONTINA
Hinged grab rail

Modell-Linie: CONTINA | CNTX70G
Grab rails | Grab rail

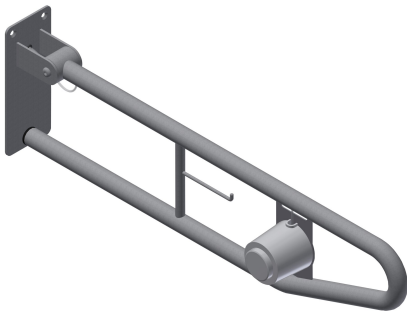

KWC-No.

2030040945

Dimensions 100 x 250 x 850 mm (W x H x D)

Foldable grab rail with flushing button for wall mounting, stainless steel, surface satin finished, rough polishing for better surface feel, 32 mm pipe diameter, material thickness 1.2 mm, integrated toilet roll holder, pneumatic flush button in front area, flush button optional on right or left side, prevention against unmeant folding, gum rubber stop absorber, 4 mm thick mounting plate with three fixing holes,

included flushing mechanism contains 2 m pneumatic tube and set for assembling to Geberit cistern, includes stainless steel screws and dowels.

Dimensions 100 x 250 x 850 mm (W x H x D)

Technical Data

back
bending angle
colour
number of fixing points
hidden fixing
hinged
material
material code
material thickness
overall depth
overall height
overall width
pipe diameter
surface finish

no
180 Degree
No colour
1
no
yes
stainless steel
1.4301 Chrome Nickel steel V2A
1.2 mm
850 mm
249 mm
100 mm
32 mm
satin finished