

## KWC F5S-Therm

Shower panel made of MIRANIT with hand shower fitting

Modell-Linie: F5S | F5ST2025  
Showers | Self closing showers

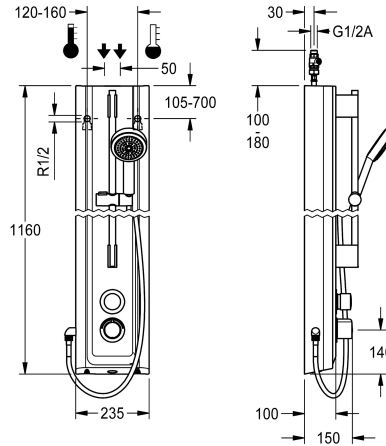

### KWC-No.

**2030056544**

F5S Therm shower panel made of mineral material for wall mounting with DN 15 self-closing thermostatic mixer and a hand shower fitting. Hydraulically controlled, for connection to hot water and cold water. Shower valve with integrated FRAMIC self-closing cartridge, thermostat and pre-assembled hygiene unit including sensor with control electronics to perform automatic water hygiene flushing, program-controlled thermal disinfection (additional bypass solenoid-operated flush valve cartridge required) and storage of statistical data. FRAMIC self-closing cartridge, low maintenance and stagnation free, with ceramic disc technology, self-closing, flow pressure independent due to the medium-independent design. Stepless adjustment of flow duration. Thermostat with metal handle, an adjustable and turn-proof temperature stop and an option for manual thermal disinfection. All-metal construction, visible parts high-polished or chrome-plated. Pre-fitted chrome-plated brass shower pole with height-adjustable hand shower holder and chrome-plated plastic hand shower,

shower head with rain jet, diameter 110 mm, shower hose 900 mm. Housing with raised function surface made of MIRANIT resin-bonded mineral material with pore-free smooth surface (temperature-resistant up to 80 °C), Alpine white colour. Connecting hoses with lockable water volume control with backflow preventer and strainer. Activated water hygiene flushing at fixed intervals of 24 hours. With option for parameterization and communication via the optional bidirectional remote control. Optional hygiene unit for battery operation with 6 V lithium battery (CR-P2) per fitting or separate power supply via plug-in power supply unit 6.75 V/12 V DC.

Dimensions of housing 235 x 1160 x 100 mm (W x H x D)

Battery compartment including battery or plug-in power supply unit with extension cable to be ordered separately.

### Technical Data

additional connections
with backflow preventer
circulation
compatible A3000 open
connection with pay water disp
default automatic hygiene flus
with filter
adjustable flow time
functional principle
for hand shower
hygiene flushing
diameter nominal
inlet size
Locking mechanism
material casing
material code casing
material fitting
maximum flow time

no
yes
no
no
not possible
fixed interval 24 hours
yes
yes
hydraulic self-closing
yes
yes
DN 15
G 1/2 A
Top section, ceramic
mineral material
Miranit
brass
35 Seconds

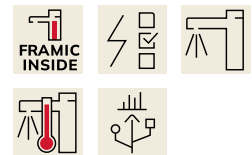

## KWC F5S-Therm

Shower panel made of MIRANIT with hand shower fitting

**Modell-Linie: F5S | F5ST2025**

Showers | Self closing showers

minimum flow pressure	1 bar
minimum flow time	5 Seconds
type of mixing	with thermostat
overall depth	100 mm
overall height	1,160 mm
overall width	235 mm
Parameterization	remote control
power supply connection	6,75 / 12 V DC
position of power connection	from top / backside
Type of power supply	Other
protective system IP	IP59K
with rosettes/cover plate	yes
protective shutdown	no
shower pipe draining	no
with shower set	yes
sound insulation	no
surface finish fitting	chromed
surface treatment fitting	polished
temperature limit	yes
thermal disinfection	yes
with transformer/power supply	no
type of mounting	wall mounting
type of operation	manual operation
type of sensor	opto-electronic sensor
type of shower	shower panel
water connection	hose (gland nut)
position of water connection	from top / backside
with soap dish	no
Accent colour	chrome-look (glossy)
Basic colour	white

### Mandatory Accessories

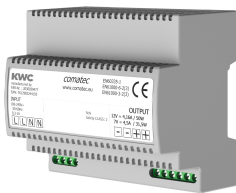

**Power supply unit**

**2030039477**  
ACEX9001

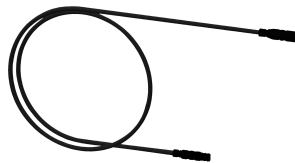

**Extension cable 5 m**

**2030043814**  
ACEX9010

## KWC F5S-Therm

Shower panel made of MIRANIT with hand shower fitting

Modell-Linie: F5S | F5ST2025  
Showers | Self closing showers

### Optional Accessories



**Bidirectional remote control for  
electronical fittings F3 and F5**

**2030036654**  
ACEX9005



**2-button remote control for fittings F3  
and F5**

**2030036849**  
ACEX9004

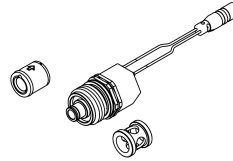

**Set for thermal disinfection**

**2030057940**  
ACXT2001



**Housing extension for F5 shower  
panels made of MIRANIT**

**2030057071**  
ACXX2016

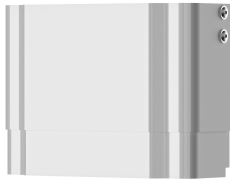

**Housing extension for F5 shower  
panels made of MIRANIT**

**2030057072**  
ACXX2017

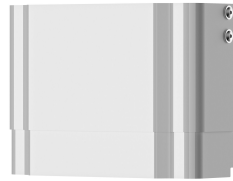

**Housing extension for F5 shower  
panels made of MIRANIT**

**2030057073**  
ACXX2018



**Housing extension for F5 shower  
panels made of MIRANIT**

**2030057075**  
ACXX2019



**Housing extension for F5 shower  
panels made of MIRANIT**

**2030057076**  
ACXX2020

### Spare Parts



**Hand shower**

**2030051216**  
ACXX2007



**Cover**

**2030031443**  
ESHOW0059

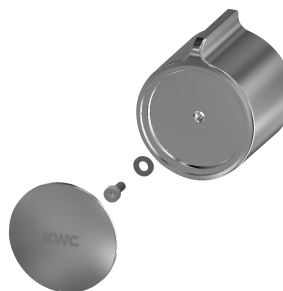

**Temperature handle**

**2030047082**  
ASXT9003

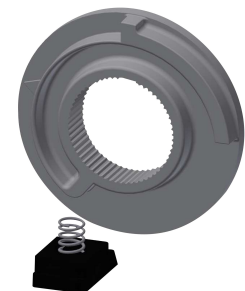

**Temperature stop**

**2030003296**  
EAQLT0003

## KWC F5S-Therm

Shower panel made of MIRANIT with hand shower fitting

Modell-Linie: F5S | F5ST2025

Showers | Self closing showers



**Plug chromed**

**2030053006**  
ASSX9004



**Push cap**

**2030049943**  
ASST2001



**Safety ring**

**2030048357**  
ASSX9003

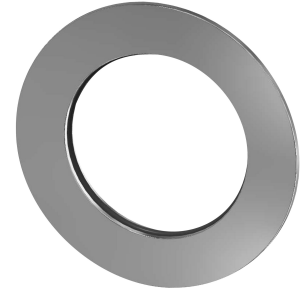

**Rosette**

**2030048765**  
ASET2006



**FRAMIC Self-closing cartridge**

**2030046145**  
ASSX9001

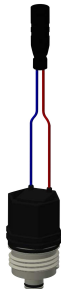

**Solenoid valve cartridge**

**2030003033**  
EAQFU0001