

KWC
WC flushing system with bidet flush valve

Modell-Linie: HIGH-SECURITY | FRK401162C
Flushing systems | Self closing wc flushing system

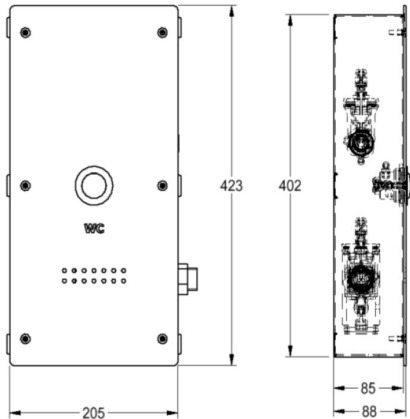

KWC-No.
2030062011

WC flushing system with bidet flush valve for installation in walls with enhanced safety in applications with an impending risk of vandalism, e.g. in prisons, has stainless steel cover plate SS304L grade, includes flush valve DN 20 for WC and flush valve DN 15 for Bidet, 1pc remote control, mounting box and basic installation kit for in-wall mounting consisting of countersunk security screws and

dowels.
Dimensions 205 x 423 x 88mm (W x H x D)
This product is intended for WC with remote control on right side (can be order separately)

Technical Data

functional principle
diameter nominal
material casing
material code casing
surface finish
type of flushing fitting
type of mounting
type of operation

hydraulic self-closing
DN 20
stainless steel
1.4301 Chrome Nickel steel V2A
satin finished
WC flush valve
in-wall installation with box
manual operation

Optional Accessories

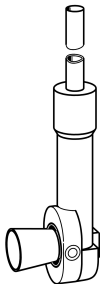

Flushing pipe for in-wall installation
2000101466
AQRM920