

KWC MEDCARE Joint for curtain rod

Modell-Linie: MEDCARE | ZMEDC0001
Grab rails | Complementary parts grab rails

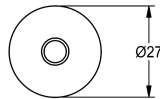
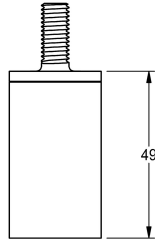

KWC-No.

360003786
MEDCARE joint for curtain rod

NEW

MEDCARE removable joint for ceiling mounting of curtain rods, made of anodised aluminium, suitable for suicide prevention, for a tensile

load of approx. 30 kg, expansion bolt included.

Technical Data

quantity
quantity uom

1
piece