

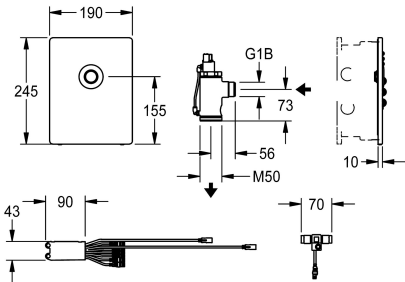

**KWC** F5E - A3000 open  
WC flush valve for in-wall installation

**Modell-Linie:** F5E | F5EF4007  
Flushing systems | Electronic WC flushing systems



**KWC-No.**

**3600005635**

F5E - A3000 open electronic WC flush valve for in-wall installation, with piezo push-button

NEW

F5E - A3000 WC flush valve DN 20 as finished installation kit for in-wall installation in basic installation kit, electronically controlled. With solenoid flush valve fitting group I including enclosed throttle insert to reduce the flush volume, holding frame with profile seal and stainless steel cover plate 190 x 245 mm with integrated piezo push-button and covered screw fixing. With waterproof electronic

module with an additional input for customer-provided sensors (buttons), maximum distance to electronic module 5 m and electric T-junction for connection to system cable. Depth adjustability 20 mm. Activated hygiene flushing 24 hours after last operation. With facility for parameterisation, cleaning stop and communication via ECC2 function controller, 24 V DC.

**Technical Data**

Built-in fitting model
Cover plate height
Cover plate width
default automatic hygiene flus
Flushing volume adjustable
functional principle
hygiene flushing
diameter nominal
maximum flushing flow
minimum flow pressure
Parameterization
power supply connection
Type of power supply
protective shutdown
with transformer/power supply
type of flushing fitting
type of mounting
type of operation
type of sensor

Finishing section
245 mm
190 mm
24h after the last activity
yes
electronic self-closing
yes
DN 20
1.3 l/s
1.2 bar
network
A3000 open 24 V DC
Transformer
yes
no
WC flush valve
in-wall installation with box
sensor operation
piezo-electronic sensor

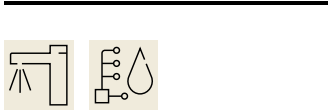

**Mandatory Accessories**



**KWC F5E - A3000 open**  
WC flush valve for in-wall installation

**Modell-Linie: F5E | F5EF4007**  
Flushing systems | Electronic WC flushing systems

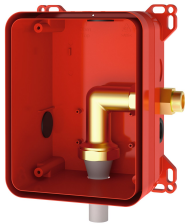

**R3 system box for WC flush valve**  
**2030068205**  
F3BF4001

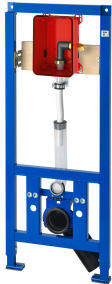

**AQUAFIX installation frame with WC flush valve for in-wall installation**  
**3600005980**  
AQFX0012

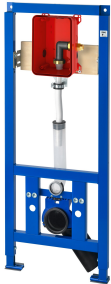

**AQUAFIX installation frame for barrier-free WC systems, with WC flush valve for in-wall installation**  
**3600005981**  
AQFX0013



**ECC2 function controller**  
**2000108123**  
ZA3OP0011



**ECC2 function controller**  
**2030016282**  
ZA3OP0022

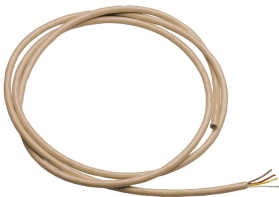

**System cable**  
**2000100801**  
ZAQUA077

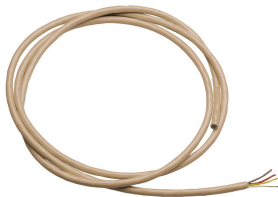

**System cable**  
**2000100852**  
ZAQUA078



**System cable**  
**2000104274**  
ZAQUA012

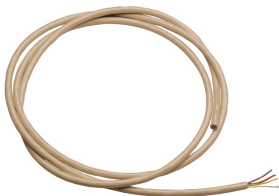

**System cable**  
**2000104272**  
ZAQUA011

**Optional Accessories**

KWC F5E - A3000 open  
WC flush valve for in-wall installation

Modell-Linie: F5E | F5EF4007  
Flushing systems | Electronic WC flushing systems

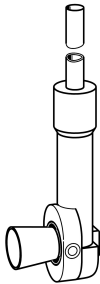

Flushing pipe for in-wall installation

2000101466  
AQRM920

Spare Parts

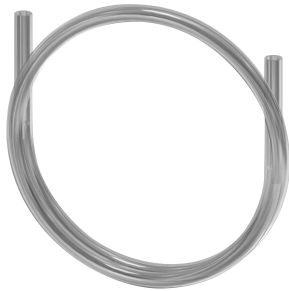

Remote operation hose

2000104803  
EAQLN0019



Electrical T junction

2000100853  
ZAQUA075

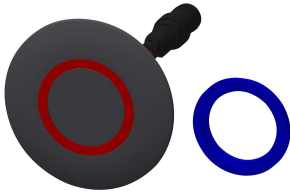

Piezo Switch

2000104441  
EAT300001

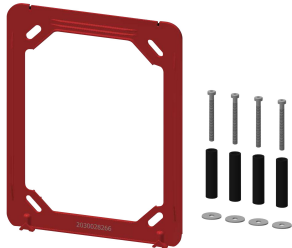

Holding frame

2030045472  
ASXX9004



Stainless steel care set

2000109019  
ZWSPL0024



Cleaning product CHROMOL

2000105091  
ZWSPL0023