

KWC F3S

Shower panel made of MIRANIT with waterfall shower

Modell-Linie: F3S | F3SV2016 | 3600007159 | EAN/GTIN: 7612987612041

Showers | Self closing showers

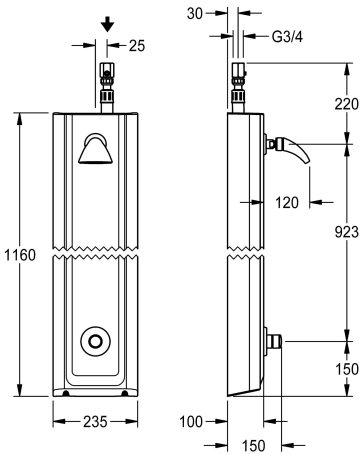

Article Number

3600007159

F3S shower panel made of mineral material for wall mounting with DN 20 self-closing gate valve and waterfall shower. Hydraulically controlled, for connection from above to pre-mixed hot or cold water. Self-closing functional part, piston-free design, self-closing and stepless adjustment of flow duration. Valve housing including shuttle valve seat, visible parts polished chrome-plated. DN 15 waterfall shower with ball joint and rosette.

Adjustable jet tilt angle 28°. Polished chromium-plated brass. Housing with raised function surface made of MIRANIT resin-bonded mineral material with pore-free smooth surface (temperature-resistant up to 80 °C), Alpine white colour. Connecting hose with lockable water flow regulator and strainer.

Dimensions of housing 235 x 1160 x 100 mm (W x H x D)

Technical Data

additional connections	no
with backflow preventer	no
circulation	no
compatible A3000 open	no
connection with pay water disp	not possible
with filter	yes
adjustable flow time	yes
functional principle	hydraulic self-closing
for hand shower	no
hygiene flushing	no
diameter nominal	DN 20
inlet size	DN 20
Locking mechanism	Top section, non-ceramic
material casing	mineral material
material code casing	Miranit
material fitting	brass-look
maximum flow time	30 Seconds
minimum flow pressure	1 bar
minimum flow time	5 Seconds
type of mixing	no
overall depth	100 mm
overall height	1,160 mm
overall width	235 mm

KWC F3S

Shower panel made of MIRANIT with waterfall shower

Modell-Linie: F3S | F3SV2016 | 3600007159 | EAN/GTIN: 7612987612041

Showers | Self closing showers

with rosettes/cover plate	yes
protective shutdown	no
shower pipe draining	no
Shower head	with shower head
with shower set	no
sound insulation	no
surface finish fitting	chromed
surface treatment fitting	polished
temperature limit	no
thermal disinfection	no
adjustable tilt angle	yes
type of mounting	wall mounting
type of operation	manual operation
type of shower	shower panel
type of shower head	drench shower head
volume flow rate at 3 bar	0.98 l/s
water connection	hose (gland nut)
position of water connection	above
with soap dish	no
Accent colour	chrome-look (glossy)
Basic colour	white

Optional Accessories



Housing extension for F5 shower panels
made of MIRANIT

2030057072
ACXX2017



Housing extension for F5 shower panels
made of MIRANIT

2030057073
ACXX2018



Housing extension for F5 shower panels
made of MIRANIT

2030057076
ACXX2020



Housing extension for F5 shower panels
made of MIRANIT

2030057075
ACXX2019



KWC F3S

Shower panel made of MIRANIT with waterfall shower

Modell-Linie: F3S | F3SV2016 | 3600007159 | EAN/GTIN: 7612987612041
Showers | Self closing showers

Housing extension for F5 shower panels
made of MIRANIT

2030057071
ACXX2016

Spare Parts



Drench shower for wall mounting

2030034417
SHHE0004

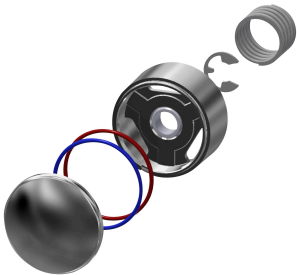

Push cap

2030042960
ASSV2001



Push-on rosette

2000104892
EAQLN0008



O-Ring, red

2030042961
ASSV2002

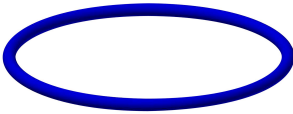

O-Ring, blue

2030042962
ASSV2003

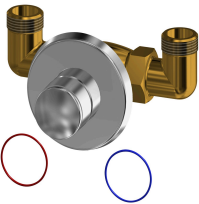

F3S self-closing gate valve for
installation in stainless steel panelling
for showers

3600009676
ASSV2013



Hexagonal socket wrench

2000106127
ZFITG0003