

KWC STRATOS  
Toilet roll holder for wall mounting

Modell-Linie: STRATOS | STR671  
Accessories | WC-roll holders

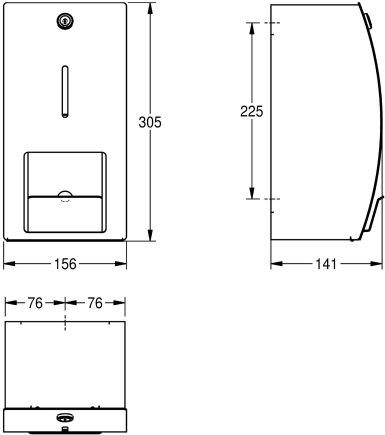

Article Number

3600008882  
Dimensions 156 x 305 x 141 mm (W x H x D)

STRATOS double toilet roll holder without spindle system for wall mounting, stainless steel, surface satin finished, material thickness 1.5 mm, closed casing with curved front and inspection window, cylinder lock with key, for two rolls with a maximum diameter of

120 mm, second roll falls into dispenser position when flap is opened, mounting material included.

Dimensions 156 x 305 x 141 mm (W x H x D)

Technical Data

maximum depth/diameter of cons	120 mm
maximum width of consumable	100 mm
filling quantity	2
filling quantity uom	rolls
lock	key-lock
material	stainless steel
material code	1.4301 Chrome Nickel steel V2A
material thickness	1.5 mm
overall depth	141 mm
overall height	305 mm
overall width	156 mm
spindle	no
type of fixing	screw
type of mounting	wall mounting