

KWC STRATOS  
Jumbo roll holder for wall mounting

Modell-Linie: STRATOS | STR670  
Accessories | WC-roll holders

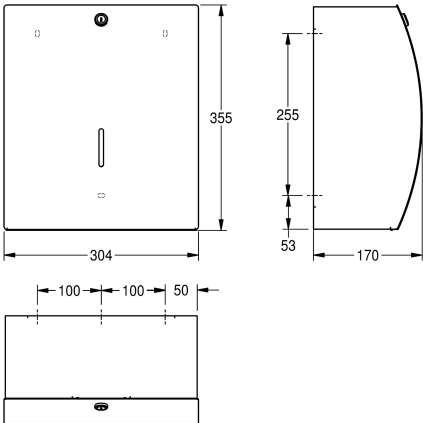

KWC-No.

**3600008884**  
Dimensions 304 x 355 x 170 mm (W x H x D)

STRATOS jumbo toilet roll holder for wall mounting, stainless steel, surface satin finished, material thickness 1.5 mm, closed casing with curved front and inspection window, paper dispenser with two serrated tear-off edges, cylinder lock with key, for one large roll with

maximum diameter 295 mm and maximum depth 105 mm, including mounting material.

Dimensions 304 x 355 x 170 mm (W x H x D)

Technical Data

maximum depth/diameter of cons	295 mm
maximum width of consumable	105 mm
filling quantity	1
filling quantity uom	rolls
lock	key-lock
material	stainless steel
material code	1.4301 Chrome Nickel steel V2A
material thickness	1.5 mm
overall depth	170 mm
overall height	355 mm
overall width	304 mm
spindle	yes
type of fixing	screw
type of mounting	wall mounting