

KWC STRATOS  
Jumbo roll holder for wall mounting

Modell-Linie: STRATOS | STR670  
Accessories | WC-roll holders

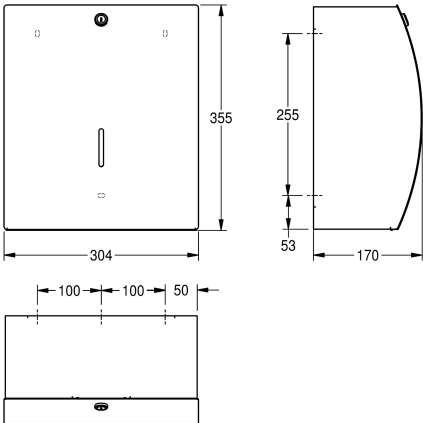

KWC-No.

3600008884

Dimensions 304 x 355 x 170 mm (W x H x D)

STRATOS jumbo toilet roll holder for wall mounting, stainless steel, surface satin finished, material thickness 1.5 mm, closed casing with curved front and inspection window, paper dispenser with two serrated tear-off edges, cylinder lock with key, for one large roll with

maximum diameter 295 mm and maximum depth 105 mm, including mounting material.

Dimensions 304 x 355 x 170 mm (W x H x D)

Technical Data

maximum depth/diameter of cons
maximum width of consumable
filling quantity
filling quantity uom
lock
material
material code
material thickness
overall depth
overall height
overall width
spindle
type of fixing
type of mounting

295 mm
105 mm
1
rolls
key-lock
stainless steel
1.4301 Chrome Nickel steel V2A
1.5 mm
170 mm
355 mm
304 mm
yes
screw
wall mounting