

KWC EXOS.
Hand dryer

Modell-Linie: EXOS | EXO220B | 3600008901 | EAN/GTIN: 7612987159744
Hand and hair dryers | Hand dryers

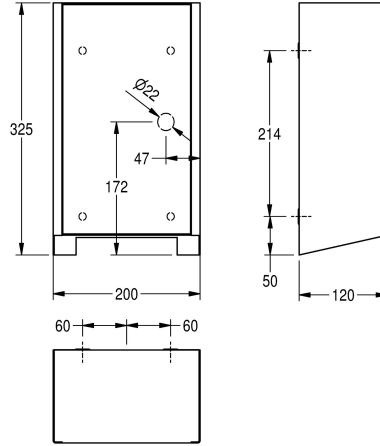

Article Number

3600008883
Front stainless steel

3600008901
Stainless steel main housing, black toughened safety glass front panel

3600008937
Stainless steel main housing, white toughened safety glass front panel

Accent colour

stainless steel-look

black

white

EXOS hand dryer for wall mounting, made of stainless steel, surface satin finished, front black toughened safety glass, material thickness 1.2 mm, with non-contact opto-electronically controlled proximity sensor, adjustable warm air temperature, sensor range adjustable from 10-25 cm, continuous operation protection with automatic switch-off after 60 seconds, adjustable air velocity, cable and plug provided by customer.

Heater: 500 W
Motor: 500 W
Air volume: 80 m³/h
Air velocity: 95-115 m/s
Noise level: 76.2 dB(A)
Protection class IPX1
Protection class I

Connection voltage: 230 V, 50-60 Hz
Total power: 1000 W

Dimensions 200 x 325 x 120 mm (W x H x D)

Technical Data

air velocity	adjustable
blower output	80 Cubic Meter/Hour
input supply voltage Hz	50 Hertz (1/second)
input supply voltage V	220 Volt
input supply voltage V max	240 Volt
input supply voltage V min	220 Volt
heating power	500 Watt
material	stainless steel
material code	1.4301 Chrome Nickel steel V2A
material thickness	1.2 mm
motor power	500 Watt
overall depth	120 mm
overall height	325 mm
overall width	200 mm
protective system IP	IPX1
sound level	76.2 Decibels (A Weighting)
total power	1,000 Watt

KWC EXOS.
Hand dryer

Modell-Linie: EXOS | EXO220B | 3600008901 | EAN/GTIN: 7612987159744
Hand and hair dryers | Hand dryers

type of fixing	screw
type of mounting	wall mounting
type of operation	sensor operation
Accent colour	black

Optional Accessories



**Interchangeable front panels for EXOS.
hand dryers**

3600008950
ZEXO220



**EXOS. front cover with white safety
glass panel**

2030035360
ZEXOS220W