

## KWC EXOS. Hand dryer

Modell-Linie: EXOS | EXO220B  
Hand and hair dryers | Hand dryers

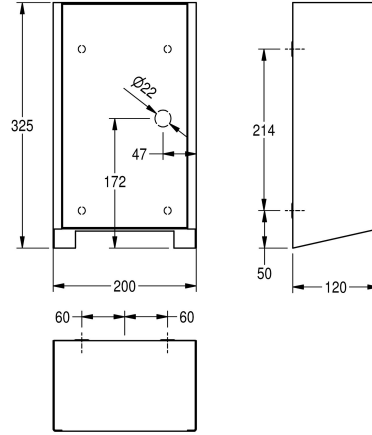

### KWC-No.

**360008883**  
Front stainless steel

**360008901**  
Stainless steel main housing, black toughened safety glass front panel

**360008937**  
Stainless steel main housing, white toughened safety glass front panel

### Accent colour

stainless steel

black

white

EXOS hand dryer for wall mounting, made of stainless steel, surface satin finished, front black toughened safety glass, material thickness 1.2 mm, with non-contact opto-electronically controlled proximity sensor, adjustable warm air temperature, sensor range adjustable from 10-25 cm, continuous operation protection with automatic switch-off after 60 seconds, adjustable air velocity, cable and plug provided by customer.

Connection voltage: 230 V, 50-60 Hz  
Total power: 1000 W

Heater: 500 W  
Motor: 500 W  
Air volume: 80 m<sup>3</sup>/h  
Air velocity: 95-115 m/s  
Noise level: 76.2 dB(A)  
Protection class IPX1  
Protection class I

Dimensions 200 x 325 x 120 mm (W x H x D)

### Technical Data

air velocity
blower output
input supply voltage Hz
input supply voltage V
input supply voltage V max
input supply voltage V min
heating power
material
material code
material thickness
motor power
overall depth
overall height
overall width
protective system IP
sound level
total power
type of fixing

adjustable
80 Cubic Meter/Hour
50 Hertz (1/second)
220 Volt
240 Volt
220 Volt
500 Watt
stainless steel
1.4301 Chrome Nickel steel V2A
1.2 mm
500 Watt
120 mm
325 mm
200 mm
IPX1
76.2 Decibels (A Weighting)
1,000 Watt
screw

## KWC EXOS. Hand dryer

Modell-Linie: EXOS | EXO220B  
Hand and hair dryers | Hand dryers

type of mounting

wall mounting

type of operation

sensor operation

Accent colour

black

### Optional Accessories



Interchangeable front panels for  
EXOS. hand dryers

**360008950**  
ZEXO220



EXOS. front cover with white safety  
glass panel

**2030035360**  
ZEXOS220W