

KWC EXOS.
Hand dryer

Modell-Linie: EXOS | EXO220B | 3600008901 | EAN/GTIN: 7612987159744
Hand and hair dryers | Hand dryers

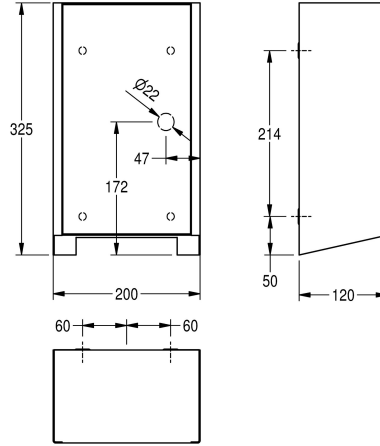

Article Number

3600008883
Front stainless steel

3600008901
Stainless steel main housing, black toughened safety glass front panel

3600008937
Stainless steel main housing, white toughened safety glass front panel

Accent colour

stainless steel

black

white

EXOS hand dryer for wall mounting, made of stainless steel, surface satin finished, front black toughened safety glass, material thickness 1.2 mm, with non-contact opto-electronically controlled proximity sensor, adjustable warm air temperature, sensor range adjustable from 10-25 cm, continuous operation protection with automatic switch-off after 60 seconds, adjustable air velocity, cable and plug provided by customer.

Heater: 500 W
Motor: 500 W
Air volume: 80 m³/h
Air velocity: 95-115 m/s
Noise level: 76.2 dB(A)
Protection class IPX1
Protection class I

Connection voltage: 230 V, 50-60 Hz
Total power: 1000 W

Dimensions 200 x 325 x 120 mm (W x H x D)

Technical Data

| | |
|----------------------------|--------------------------------|
| air velocity | adjustable |
| blower output | 80 Cubic Meter/Hour |
| input supply voltage Hz | 50 Hertz (1/second) |
| input supply voltage V | 220 Volt |
| input supply voltage V max | 240 Volt |
| input supply voltage V min | 220 Volt |
| heating power | 500 Watt |
| material | stainless steel |
| material code | 1.4301 Chrome Nickel steel V2A |
| material thickness | 1.2 mm |
| motor power | 500 Watt |
| overall depth | 120 mm |
| overall height | 325 mm |
| overall width | 200 mm |
| protective system IP | IPX1 |
| sound level | 76.2 Decibels (A Weighting) |
| total power | 1,000 Watt |

KWC EXOS.
Hand dryer

Modell-Linie: EXOS | EXO220B | 3600008901 | EAN/GTIN: 7612987159744
Hand and hair dryers | Hand dryers

| | |
|-------------------|------------------|
| type of fixing | screw |
| type of mounting | wall mounting |
| type of operation | sensor operation |
| Accent colour | black |

Optional Accessories



**Interchangeable front panels for EXOS.
hand dryers**

3600008950
ZEXO220



**EXOS. front cover with white safety
glass panel**

2030035360
ZEXOS220W