

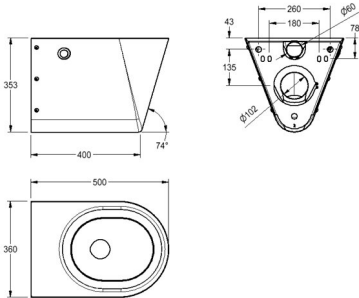

KWC CAMPUS  
Wall hung WC pan

Modell-Linie: CAMPUS | AEF108  
WCs and urinals | WCs



KWC-No.
2000100133
Without toilet seat
2000100134
With 2 toilet seat pads
3600000629
With black toilet seat
3600000650
With grey toilet seat
3600000651
With white toilet seat
3600011649
with bidet and its remote control(button) on the left side

type of toilet seat
No seat
synthetic seat pad
synthetic hinged seat with lid
synthetic hinged seat with lid
synthetic hinged seat with lid
No seat

Wall hung WC pan, stainless steel, surface satin finished, material thickness 1,5 mm, flushing certificated to EN 997, concealed flushing rim with min. 4 liter flushing capacity, with a shrouded 100 mm diameter horizontal 'P' trap outlet, pressed seat area tapered towards centre, all edges curved, fixing with mounting plate supplied, conform to EN 33, includes security screws. 4 litre flush EN

997 approved, with bidet and its remote control(button) on the left side, without seat and lid.  
  
Dimensions 360 x 353 x 500 mm (W x H x D)  
Suitable flushing system: 2030062011-FRK401162C WC Flushing Sys w/ Bidet F.V

Technical Data

inlet size
material
material code
material thickness
minimum flushing capacity
outlet size
overall depth
overall height
overall width
surface finish
type of mounting
type of toilet seat
type of WC

DN 55
stainless steel
1.4301 Chrome Nickel steel V2A
1.5 mm
4 Liter
DN 100
500 mm
353 mm
360 mm
satin finished
wall mounting
No seat
wall hung