

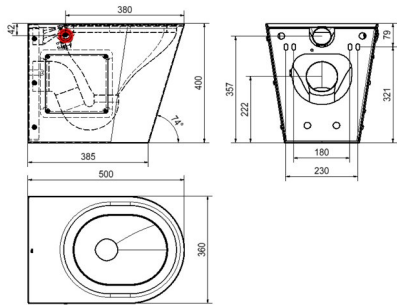

KWC CAMPUS  
Wall hung WC pan

Modell-Linie: CAMPUS | AEF106  
WCs and urinals | WCs



KWC-No.
<b>2000100153</b> Version for installation from the front, with mounting plate and anti-theft screw fixings
<b>2000100154</b> With 2 toilet seat pads
<b>3600000655</b> With black toilet seat
<b>3600000656</b> With grey toilet seat
<b>3600000657</b> With white toilet seat
<b>3600017390</b> with bidet and its remote control(button) on the right side

Wall hung WC pan with shroud to the floor, stainless steel, surface satin finished, material thickness 1.5 mm, flushing certificated to EN 997, concealed flushing rim with min. 4 litre flushing capacity, with a shrouded 100 mm diameter horizontal 'P' trap outlet, pressed seat area tapered towards centre, all edges curved, fixing with included mounting plate conform to EN 33, including safety screws, 4 litre

Technical Data
inlet size
material
material code
material thickness
minimum flushing capacity
outlet size
overall depth
overall height
overall width
surface finish
type of mounting
type of toilet seat
type of WC

type of toilet seat
No seat
synthetic seat pad
synthetic hinged seat with lid
synthetic hinged seat with lid
synthetic hinged seat with lid
No seat

flush EN997 approved, with bidet and its remote control(button) on the right side, without seat and lid, access panel for maintenance on right side only.

Dimensions 360 x 400 x 500 mm (W x H x D)

DN 55
stainless steel
1.4301 Chrome Nickel steel V2A
1.5 mm
4 Liter
DN 100
500 mm
400 mm
360 mm
satin finished
wall mounting
No seat
wall hung

Mandatory Accessories



## **KWC** CAMPUS Wall hung WC pan

**Modell-Linie: CAMPUS | AEF106**  
WCs and urinals | WCs



**WC flushing system with bidet flush valve**

---

**2030062011**  
FRK401162C

---